

Rates

Studio A

Pre-light/shoot:	\$2,800/day
Power:	pay-per-use
Overtime:	\$400/hour*
Build/Strike:	\$1,400/day

Studio B

Pre-light/shoot:	\$1,500/day
Power:	pay-per-use
Overtime:	\$250/hour*
Build/Strike:	\$750/day

Studios A & B

Pre-light/shoot:	\$4,000/day
Power:	pay-per-use
Overtime:	\$500/hour*
Build/Strike:	\$2,000/day

*Overtime rates apply after 10 hours
or outside of 6:00 AM - 10:00 PM

Paint

The cove and floor must be kept in good condition. We recommend keeping the floor covered to avoid any potential repainting charges. Absolutely no drilling into the cove or attachments to the cove are permitted. The Studio A cove can be painted any color, but must be returned to the original color at the project's end.

The cost for painting the Studio A **cove** any color is \$4,800. (This price includes painting it back to its original color.)

The cost for painting the Studio A **floor** any color is \$1,800. (This price includes painting it back to its original color.)

Specifications

Studio A

70' x 50' x 16' - Quiet HVAC
 55' x 25' hard cyc (green & white, can be painted other colors)
 2400 Amps 3-phase power
 12 - 20 Amp 120V circuits, floor level Edison plugs
 12' x 11' 8" wide street level loading door
 Cove is pre-lit with 2K spacelights
 1 - 600 Amp 3-phase distro box
 2 - 100 Amp lunch boxes
 4-50' 100Amp Bates Cable, 1-25'Amp Bates Cable

Studio B

50' x 40' x 15'8" - Quiet HVAC
 38' x 22' 6" White wall/ Epoxy Floor with seam
 1200 Amps 3-phase power
 9 - 20 Amp 120V circuits, floor-level Edison plugs
 12' x 11' 6" wide street level loading door

Definitions

A Full Day is 10 hours, a Half Day is 5 hours. Half Day rates are 60% of the Full Day rate.
 Overtime rates apply for all times in excess of 10 hours or outside of 6:00 AM to 10:00 PM.

A Booking is a confirmed reservation in which the client is guaranteed the desired date or dates.
 Bookings are valid upon confirmed receipt of a 50% rental deposit, a signed contract and a \$200 cleaning deposit.
 A certificate of insurance naming Meets The Eye, LLC as Certificate Holder must be received prior to the booked date.

Cancellation of bookings will be subject to the following penalties and will be billed as follows:

10 days or more prior to booking date:	no charge
3 days notice prior to booking date:	25% of all days booked, up to a maximum of one week
2 days prior to booking date:	50% of all days booked, up to a maximum of one week
Less than 2 days prior to booking date:	100% of all days booked, up to a maximum of one week

All areas used must be cleaned and brought back to their original condition at the end of the production, otherwise MTE may retain the cleaning deposit.

Terms & Conditions

Clients renting from Meets The Eye, LLC, (hereinafter referred to as "MTE") will review and sign, if productions studio, equipment, and services are in satisfactory condition and working order upon review at time of rental..

Rental Clients (hereinafter referred to as "Client") agree to indemnify and hold harmless MTE and its officers and employees from any and all suits, claims, damages, and liabilities, including Workers' compensation claims, resulting directly or indirectly from a cause of occurrence in, upon, at, or from the use of the rented facility and equipment herein, unless to such damage or injury which may be caused by the gross negligence of MTE

MTE indemnifies and holds harmless DPEM and DPEM's officers, directors, affiliates, employees, agents and advisors (collectively, "Indemnified Parties") from and against any and all claims, demands, actions, suits, judgments, penalties, fines, losses, costs and expenses (including attorneys' fees and litigation costs) (collectively "Claims") that the Indemnified Parties may incur as the result of any breach of this Agreement by the Indemnifying Party or as the result of the Indemnifying Party's infringement of any third party intellectual property rights. The foregoing indemnification obligations shall survive termination of this Agreement..

MTE makes no warranty, either expressly, implied, orally, written, or otherwise regarding the merchantability, fitness, operation or use of the studio and its equipment for any particular purpose.

Payment

MTE reserves the right to change prices until a signed contract with deposit is received with prior notice to client. MTE reserves the right to collect all applicable taxes where required.

A deposit of 50% of the rental fee plus a \$200 cleaning deposit and a signed contract are required to book the studio.

The rental balance is due upon first shoot day. A 1.5% service charge, to increase by an additional 1.5% every 30 days thereafter.

Insurance

Liability Insurance. The Client shall, at its own expense, maintain commercial general liability insurance ("liability insurance"), including coverage for the operations of independent contractors and standard contractual liability coverage. The liability insurance shall name Meets The Eye, LLC as an additional insured and provide that said insurance is primary coverage with respect to all insured, the limits of which must be exhausted before any obligation arises under our insurance. Such insurance shall remain in effect during the course of this agreement, and shall include, without limitation, the following coverages: standard contractual liability, personal injury liability, completed operations, and product liability. The liability insurance shall provide general aggregate limits of not less than \$2,000,000 (including the coverage specified above) and not less than \$1,000,000 per occurrence.

Valuation of loss. Unless otherwise agreed in writing, the Client shall be responsible to MTE for the replacement or repair costs of the equipment and/or facilities (if the equipment and/or facilities can be restored, by repair, to their pre-loss condition) whichever is less. If there is a reason to believe a theft has occurred, Client shall file a police report. Loss of use shall be determined by the actual loss sustained by MTE as a result of Client's use of premises.. Accrued rental charges shall not be applied against the purchase price or cost of repair of the lost, stolen or damaged equipment.

Subrogation. The Client hereby agrees that MTE shall be subrogated to any recovery rights the Client may have for damage to the equipment rented/leased.

Workers' compensation insurance. Client shall, at their own expense, maintain workers' compensation/employer's liability insurance during the course of the booking at MTE with minimum limits of \$1,000,000.

Termination

MTE and its staff reserve the right to terminate at any time any booking that is deemed to be operating in an unsafe manner or in violation of any Federal, State and/or Municipal laws. California Law shall govern any dispute arising from this rental agreement. If any action or proceeding arising out of or relating to this rental policy, including an action for declaratory relief, is commenced by either party to this rental policy, then as between MTE and Clients the prevailing party shall be entitled to recover from the other party, in addition to any other costs and relief that may be granted, the reasonable attorneys fees incurred in the action or proceeding by the prevailing party. Such recovery shall include court costs and attorneys fees on appeal.

Payment Calculation

Rental Dates: _____

Studio A

Includes Rooms 103, 104, 108, 112, 114, 115, 116, the upstairs kitchen, and Studio A cafe.

Studio B

Includes Rooms 100, 102, 107, the downstairs kitchen, and the Studio B greenroom.

Studios A & B

Includes all production areas and rooms except for the MTE offices.

Additional rooms may be available during your booking. Contact us to check on their availability and pricing.

To book space, please provide the following :

1) Signed Rental Agreement 2) Insurance Certificate 3) Deposit

Build/Strike days _____ * day rate _____ = _____

Prelight/Shooting days _____ * day rate _____ = _____

Sum of Build/Strike and Prelight/Shooting = Total rental _____ * 50% = _____

Security/Cleaning Deposit + \$200.00

Deposit required for booking _____

Payment by Cash Check Credit Card

Name on Card _____

Billing address _____

City _____ State _____ Zip _____

Card number _____

Exp mm/yyyy _____ Security Code (CVS) _____

Email Booking Form to: Info@meetstheeyestudios.com

Internet Connection

Meets the Eye Studios offers high-speed internet connection at the following rates:

Comcast cable wifi: 500 Mbps/down, 40 Mbps up included at no cost with MTE studio rental

ATT Fiber: 1 Gbps up and down (ideal for streaming or live events) \$500/day

Company Information

Name _____

Address _____

City _____ State _____ Zip _____

Office phone _____ Fax _____

Mobile phone _____

Email _____

The undersigned is authorized to execute this agreement and represents that the Client is both fiscally sound and responsible, and is able to meet the terms of this agreement. Unless otherwise noted here, both parties agree that this agreement shall be valid and in effect for a period of one year from the date so noted below.

Signature _____ Date _____

Print name _____

How did you hear about us?

Web Referral _____ Reel Directory Other _____

MTE Office use only

Name _____

Signature _____

Date Received _____

Date Confirmation Sent _____

940 Tanklage Road



939 Terminal Way

940 Tanklage Road

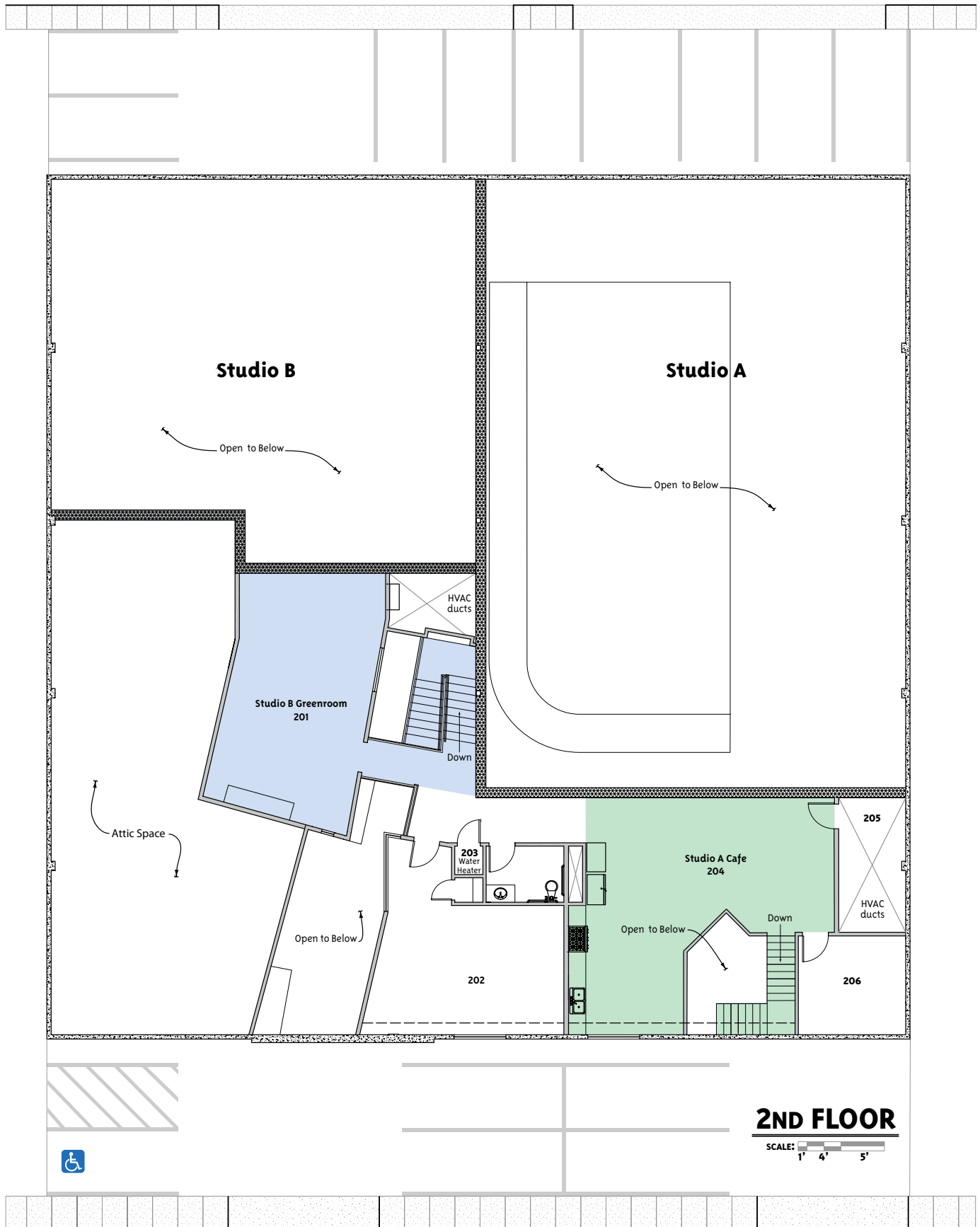

939 Terminal Way

	Equipment Rates	
Item	Description	Day rate
RED Epic body only	RED Epic MX 5k body, top mounts, handle, Pelican case	\$400.00
RED Epic basic package	RED Epic MX 5k body plus: LCD, 4 batteries, charger / AC adapter, Element Technica BNC BOB, 19mm base plate, 4 16GB CF cards OR 1 Element Technica shockmounted 320GB RED Drive with AC adapter, Pelican case.	\$700.00
RED Epic shooting kit	RED Epic MX 5k basic package plus: 4 16GB CF cards, 2 Element Technica shockmounted 320GB RED Drives with AC adapters, Red Zoom 18-85mm T3, O'Connor 2060 head, Sachtler CF Tripod, Arri Follow Focus, MB20 matte box, ND filter set, & Pelican cases.	\$1000.00
RED battery		\$25.00
RED charger		\$25.00
RED AC adaptor		
RED EVF	with Element Technica mount	\$150.00
RED LCD		\$100.00
RED Drive	with AC adapter	\$100.00
RED CF card 8GB		\$25.00
RED CF card 16 GB		\$40.00
ET V-dock drive cradle		\$20.00
ET 19 mm bridge plate		\$20.00
ET dovetail plate		\$15.00
4 Tilt Shift Lens Kit	24, 45, 90, 110mm T2.0 with Pelican Case	\$750
1 Ultra Prime	one of (16, 24, 32, 50, 65, 85, 135mm) T1.9	\$125.00
7 Ultra Primes	16, 24, 32, 50, 65, 85, 135mm T1.9 with Pelican case	\$700.00
RED 18-85mm zoom	18-85mm T3 lens with 19mm rods, lens support, & Pelican Case	\$275.00
Canon 70-200mm	70-200mm f/2.8	\$50.00
filter (4" x 5.65") each		\$15.00
MB20 matte box		\$75.00
FF4 follow focus with whip		\$60.00
Indy Dolly System	12ft track with a 3 set wheel system	\$100.00
tripod legs with spreader	150mm ball base; CF single-stage standard or aluminum single stage baby	\$25.00
O'Connor 2060 head	with ATA case	\$90.00
ET Mantis rig	with remote start/stop trigger	\$75.00
Monitor with Stand	Available: 32inch, 46inch	\$100
Panasonic 8/4" LCD	with Porta-brace case, V-mount for RED batteries. No AC adapter.	\$150.00
Dolly	Doorway Dolly Round D-Round	\$150
Cineo HSX	8 units available	\$175.00
Kino Flo Vista Beam 600	2 units available, both with 60 & 90 degree honeycomb grids	\$250.00
Kino Flo Diva Light 400	kit includes 2 units, with stands, silver grids, and flozier diffusion	\$100.00
Kino Flo Para Beam 400	2 units available with barn doors	\$100.00
Arri Pocket Par 400 HMI	kit includes lighthouse, Chimera pancake lantern, AC & DC power supplies	\$200
	Weekly rate is 3x the day rate. Monthly rate is 10x the day rate.	

Nearest Hospital - Emergency Room

Driving Directions

FROM Meets The Eye
939 Terminal Way
San Carlos, CA 94070-3224

TO Sequoia Hospital
170 Alameda de Las Pulgas
Redwood City, CA 94062-2751

Directions

Distance

START 939 Terminal Way, San Carlos, CA 94070-3224

- | | |
|--|---------|
| 1: Start out going SOUTHWEST on TERMINAL WAY toward BAYPORT AVE. | 0.23 mi |
| 2: Turn LEFT onto OLD COUNTY RD. | 0.44 mi |
| 3: Turn RIGHT onto BRITTAN AVE. | 0.04 mi |
| 4: Turn LEFT onto EL CAMINO REAL/CA-82 S. | 1 mi |
| 5: Turn RIGHT onto WHIPPLE AVE. | 0.98 mi |
| 6: Turn RIGHT onto ALAMEDA DE LAS PULGAS. | 0.06 mi |

END 170 Alameda de Las Pulgas, Redwood City, CA 94062-2751

Estimated Driving Time: 7 mins

Total Distance: 2.74 mi

